



**DISCLAIMER**

This document has been developed by RBS Store Development for use by authorized RBS Associates or consultants. It has been developed for conceptual use only and shall not be used for construction purposes. A construction document must be drawn and sealed by a licensed architect and engineer who has knowledge of the conditions, local ordinances, and all relevant government requirements for the project location. Owner makes no representation or warranty regarding the accuracy, completeness, or adequacy of this document, and assumes no responsibility for any conclusions or interpretations made on the basis of such information.

**SYMBOL LEGEND**

HINGED SCALE	S	EXISTING GUARD POST	GP
BAG RACK	B	NEW GUARD POST	GP
FIRE EXTINGUISHER	FE		
HOSE CONNECTION	HC		
EYE WASH STATION	W		

**WALL LEGEND**

INTERIOR WALL	[Symbol]
EXTERIOR WALL	[Symbol]
COOLER/FREEZER PANEL	[Symbol]
NEW EXTERIOR WALL	[Symbol]
NEW INTERIOR WALL	[Symbol]
EXISTING WALL TO BE DEMOLISHED	[Symbol]

**SCOPE OF WORK LEGEND**

CONSTRUCTION LIMIT LINE	[Symbol]
NEW ANNUAL WORK	[Symbol]
RELOCATED (REMOVED) ANNUAL WORK	[Symbol]
NEW ANNUAL WORK COMMENTS	[Symbol]
EXISTING (REMOVED) ANNUAL WORK	[Symbol]
TBD (REMOVED) ANNUAL WORK	[Symbol]

**FACILITY ANALYSIS**

**Color Legend**

- Remove
- Relocate
- New
- Mini-Set



#	MODEL	SIZE	DESCRIPTION	INT	EXT	AGE	LEGEND STORE #2839	EXISTING
01	HP	12'-0"	VOID SELF-SERVE	BLK	INTL	13	AREAS - SOFT	46,711
02	HW	12'-0"	VOID SELF-SERVE	BLK	INTL	13	TOTAL EXTERIOR STORE	12,294
03	HW	12'-0"	VOID SELF-SERVE	BLK	INTL	13	SUPPORT	33,278
04	HW	12'-0"	VOID SELF-SERVE	BLK	INTL	13	TOTAL INTERIOR STORE	45,872
05	HW	12'-0"	VOID SELF-SERVE	BLK	INTL	13	PRODUCE PREP	566
06	HW	12'-0"	VOID SELF-SERVE	BLK	INTL	13	MEAT PREP	816
07	HW	12'-0"	VOID SELF-SERVE	BLK	INTL	13	DELI BAKERY PREP	1,963
08	HW	12'-0"	VOID SELF-SERVE	BLK	INTL	13	SEAFOOD PREP	216
09	HW	12'-0"	VOID SELF-SERVE	BLK	INTL	13	PHARMACY	202
10	HW	12'-0"	VOID SELF-SERVE	BLK	INTL	13	GROCERY STAGING	4,479
11	HW	12'-0"	VOID SELF-SERVE	BLK	INTL	13	GROCERY BANNERS	12
12	HW	12'-0"	VOID SELF-SERVE	BLK	INTL	13	SALES SUPPORT RATIO	2,841.1
13	HW	12'-0"	VOID SELF-SERVE	BLK	INTL	13	SALES - GROCERY STAGING RATIO	711.1
14	HW	12'-0"	VOID SELF-SERVE	BLK	INTL	13	COOLERS & FREEZERS - SOFT	475
15	HW	12'-0"	VOID SELF-SERVE	BLK	INTL	13	PRODUCE COOLER	477
16	HW	12'-0"	VOID SELF-SERVE	BLK	INTL	13	STORAGE FREEZER	0
17	HW	12'-0"	VOID SELF-SERVE	BLK	INTL	13	ICE CREAM FREEZER	0
18	HW	12'-0"	VOID SELF-SERVE	BLK	INTL	13	DAIRY COOLER	500
19	HW	12'-0"	VOID SELF-SERVE	BLK	INTL	13	MEAT COOLER	488
20	HW	12'-0"	VOID SELF-SERVE	BLK	INTL	13	TRAY COOLER	0
21	HW	12'-0"	VOID SELF-SERVE	BLK	INTL	13	MEAT FREEZER	165
22	HW	12'-0"	VOID SELF-SERVE	BLK	INTL	13	DAIRY COOLER	89
23	HW	12'-0"	VOID SELF-SERVE	BLK	INTL	13	DELI BAKERY FREEZER	4,000RS
24	HW	12'-0"	VOID SELF-SERVE	BLK	INTL	13	DELI BAKERY COOLER	0
25	HW	12'-0"	VOID SELF-SERVE	BLK	INTL	13	PRODUCE - SINGLE DECK	60
26	HW	12'-0"	VOID SELF-SERVE	BLK	INTL	13	PRODUCE - MULTI-DECK	48
27	HW	12'-0"	VOID SELF-SERVE	BLK	INTL	13	PRODUCE - ISLAND REFRIG.	1,000RS
28	HW	12'-0"	VOID SELF-SERVE	BLK	INTL	13	FLORAL REACH IN	0
29	HW	12'-0"	VOID SELF-SERVE	BLK	INTL	13	HSPANC	0
30	HW	12'-0"	VOID SELF-SERVE	BLK	INTL	13	DELI BAKERY	12
31	HW	12'-0"	VOID SELF-SERVE	BLK	INTL	13	COLD DELI - SERVICE	40
32	HW	12'-0"	VOID SELF-SERVE	BLK	INTL	13	COLD DELI - SELF-SERVE	0
33	HW	12'-0"	VOID SELF-SERVE	BLK	INTL	13	COLD DELI - SERVICE/SELF-SERVE	0
34	HW	12'-0"	VOID SELF-SERVE	BLK	INTL	13	COLD DELI - SANDWICH STATION	0
35	HW	12'-0"	VOID SELF-SERVE	BLK	INTL	13	COLD DELI - ISLANDS	0
36	HW	12'-0"	VOID SELF-SERVE	BLK	INTL	13	HOT DELI - SELF-SERVE	0
37	HW	12'-0"	VOID SELF-SERVE	BLK	INTL	13	HOT DELI - SERVICE/SELF-SERVE	0
38	HW	12'-0"	VOID SELF-SERVE	BLK	INTL	13	HOT DELI - ISLANDS	0
39	HW	12'-0"	VOID SELF-SERVE	BLK	INTL	13	SUSHI	0
40	HW	12'-0"	VOID SELF-SERVE	BLK	INTL	13	BAKERY - SELF-SERVE REFRIG.	0
41	HW	12'-0"	VOID SELF-SERVE	BLK	INTL	13	BAKERY - SELF-SERVE NONREFRIG.	0
42	HW	12'-0"	VOID SELF-SERVE	BLK	INTL	13	FROZEN BAKERY	12
43	HW	12'-0"	VOID SELF-SERVE	BLK	INTL	13	REACH IN FROZEN BAKERY	1,000RS
44	HW	12'-0"	VOID SELF-SERVE	BLK	INTL	13	REACH IN FROZEN HMG	0
45	HW	12'-0"	VOID SELF-SERVE	BLK	INTL	13	MEAT	0
46	HW	12'-0"	VOID SELF-SERVE	BLK	INTL	13	MEAT - SERVICE	0
47	HW	12'-0"	VOID SELF-SERVE	BLK	INTL	13	MEAT - ONE/TWO DECK	0
48	HW	12'-0"	VOID SELF-SERVE	BLK	INTL	13	MEAT - FOUR/SIX DECK	48
49	HW	12'-0"	VOID SELF-SERVE	BLK	INTL	13	MEAT - FROZ.	22
50	HW	12'-0"	VOID SELF-SERVE	BLK	INTL	13	MEAT - REACH IN	0
51	HW	12'-0"	VOID SELF-SERVE	BLK	INTL	13	MEAT - REACH IN FROZEN MEAT/SEAFOOD	4,000RS
52	HW	12'-0"	VOID SELF-SERVE	BLK	INTL	13	SEAFOOD - SERVICE	0
53	HW	12'-0"	VOID SELF-SERVE	BLK	INTL	13	SEAFOOD - ONE/TWO DECK	0
54	HW	12'-0"	VOID SELF-SERVE	BLK	INTL	13	SEAFOOD - FROZ.	0
55	HW	12'-0"	VOID SELF-SERVE	BLK	INTL	13	REACH IN FROZEN SEAFOOD	0
56	HW	12'-0"	VOID SELF-SERVE	BLK	INTL	13	GROCERY	120
57	HW	12'-0"	VOID SELF-SERVE	BLK	INTL	13	DAIRY - FRONT LOAD	12
58	HW	12'-0"	VOID SELF-SERVE	BLK	INTL	13	DAIRY - REAR LOAD	0
59	HW	12'-0"	VOID SELF-SERVE	BLK	INTL	13	REACH IN FROZEN FOOD	91,000RS
60	HW	12'-0"	VOID SELF-SERVE	BLK	INTL	13	REACH IN ICE CREAM	21,000RS
61	HW	12'-0"	VOID SELF-SERVE	BLK	INTL	13	REACH IN TOTAL	116,000RS
62	HW	12'-0"	VOID SELF-SERVE	BLK	INTL	13	FROZEN FOOD ENCAP	4,000RS
63	HW	12'-0"	VOID SELF-SERVE	BLK	INTL	13	ICE CREAM ENCAP	1,000RS
64	HW	12'-0"	VOID SELF-SERVE	BLK	INTL	13	BEER	44
65	HW	12'-0"	VOID SELF-SERVE	BLK	INTL	13	REACH IN BEER	1,000RS
66	HW	12'-0"	VOID SELF-SERVE	BLK	INTL	13	WINE	2,000RS
67	HW	12'-0"	VOID SELF-SERVE	BLK	INTL	13	NATURE'S PLACE	0
68	HW	12'-0"	VOID SELF-SERVE	BLK	INTL	13	REACH IN FROZEN NATURE'S PLACE	0
69	HW	12'-0"	VOID SELF-SERVE	BLK	INTL	13	SHELVING - LINEAR FEET	256
70	HW	12'-0"	VOID SELF-SERVE	BLK	INTL	13	LOW GONDOLA	62
71	HW	12'-0"	VOID SELF-SERVE	BLK	INTL	13	SUB-TOTAL	318
72	HW	12'-0"	VOID SELF-SERVE	BLK	INTL	13	HIGH GONDOLA	152
73	HW	12'-0"	VOID SELF-SERVE	BLK	INTL	13	SUB-TOTAL	168
74	HW	12'-0"	VOID SELF-SERVE	BLK	INTL	13	GRAND TOTAL SHELVING	204

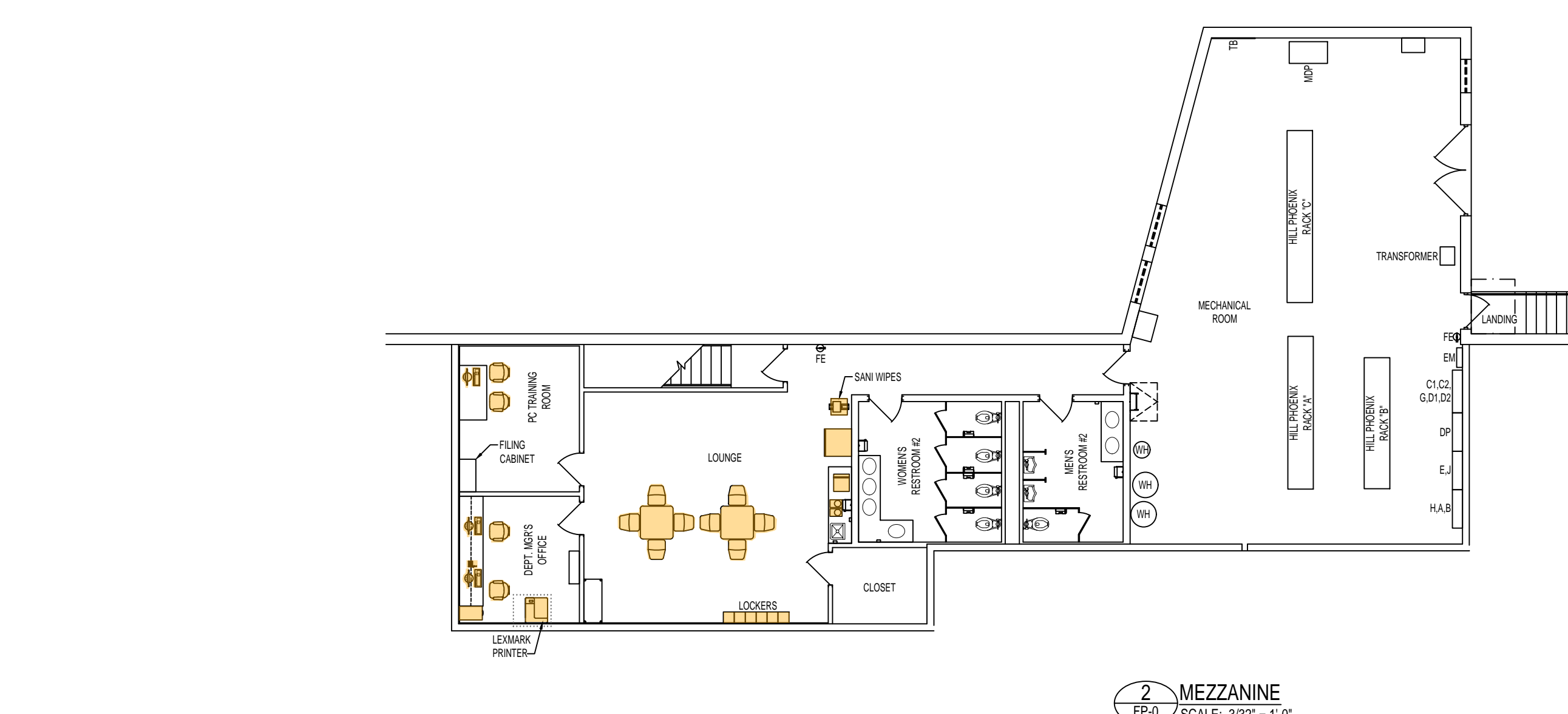

**SIGN-OFF APPROVALS**

DIRECTOR	DATE	DIRECTOR	DATE

**REVISIONS**

#	DATE	DESCRIPTION
A	12/14/2021	OFFICIAL A RELEASE

**MEETINGS**

LEADERSHIP REVIEW	###/###/###
BUSINESS OWNER REVIEW	###/###/###
OPERATIONS REVIEW	###/###/###

**PROJECT INFO**

DATE	12/14/2021	DRAWN BY	M. THOMPSON
PROJECT	OMNI DECOR	CHECKED BY	A. EDWARDS
PROJECT #	2839FLM422	PROJECT MANAGER	A. EDWARDS

**EXISTING FIXTURE PLAN**

3/32" = 1'-0"      FP-0 (A0.02)

**STORE INFO**

891 PARRIS ISLAND CTRVY STE N
BEAUFORT, SC
252' X 180'
HIGH
N/A