

GENERAL FLOORING NOTES:

- VINYL FLOOR TILE (VCT)
SEE SPECIFICATIONS FOR ACCEPTABLE ADHESIVE FOR VINYL COMPOSITION TILE (VCT).
- THE VINYL COMPOSITION TILE SHALL BE 1/8" MANUFACTURED BY ARMSTRONG.
- THE GENERAL CONTRACTOR SHALL FURNISH AN ADDITIONAL 8% OF EACH COLOR OF VCT TO BE LEFT AT THE STORE. COORDINATE WITH THE FOOD LION CONSTRUCTION MANAGER.
- THE GENERAL CONTRACTOR SHALL THOROUGHLY CLEAN AND WAX (2 COATS MINIMUM) VCT IMMEDIATELY AFTER INSTALLATION. ONLY USE CLEANER AND WAX PRODUCTS RECOMMENDED BY THE FLOOR MANUFACTURER.
- THE FLOORING INSTALLER SHALL PERFORM A CALCIUM CHLORIDE OR HUMIDITY TEST FOR EACH 1,000 SQUARE FOOT AREA WHERE FLOORING WILL BE INSTALLED. THE INSTALLER SHALL PROVIDE A REPORT TO THE FOOD LION CONSTRUCTION REPRESENTATIVE FOR ALL AREAS THAT MOISTURE FALLS ABOVE 5 POUNDS, AND PROVIDE AN APPROPRIATE DAMP PROOF MEMBRANE.
- THE GENERAL CONTRACTOR SHALL ALTERNATE THE FIELD TILES:
- CARPET/WALK OFF TILE
ENTRANCE FLOOR TILE SHALL BE "DIPLOMAT" BY PORTICO SYSTEMS WITH TAC FAST BACKING. COLOR SHALL BE "MINK". DIPLOMAT SHALL BE INSTALLED BY PORTICO SYSTEMS. CONTACT GREG GRIFFIN (884) 527-3148.
THE GENERAL CONTRACTOR SHALL FURNISH 5% EXTRA OF THE TOTAL AMOUNT OF DIPLOMAT USED, TO BE LEFT IN THE BACK ROOM OF THE STORE FOR FUTURE USE.
- PHARMACY CARPET, WHEN APPLICABLE, SHALL BE "DIPLOMAT" BY PORTICO SYSTEMS WITH TAC FAST BACKING. COLOR SHALL BE "MINK". DIPLOMAT SHALL BE INSTALLED BY PORTICO SYSTEMS. CONTACT GREG GRIFFIN (884) 527-3148.
THE GENERAL CONTRACTOR SHALL FURNISH 5% EXTRA OF THE TOTAL AMOUNT OF DIPLOMAT USED, TO BE LEFT IN THE BACK ROOM OF THE STORE FOR FUTURE USE.
- CONCRETE FLOORING
ALL PRODUCTS FOR UNDERLAYMENT OF VCT SHALL BE MAPEI TO PROVIDE A COMPLETE MAPEI SYSTEM. SEE SPECIFICATIONS.
- IN AREAS WHERE FLOOR DRAINS OCCUR, THE FINISH FLOOR SHALL SLOPE 1/16" PER FOOT TO DRAIN.
- SEAL ALL EXPOSED CONCRETE FLOORS WITH AN EXTRA COAT OF CONCRETE SEALER ONE WEEK PRIOR TO GROCERY DELIVERY. SEALER TO BE PER SPECIFICATIONS. COORDINATE WITH FOOD LION CONSTRUCTION MANAGER.
- THE GENERAL CONTRACTOR SHALL USE 10 MIL VAPOR RETARDER AT CONCRETE SLAB EDGES AND 30 LB. FELT AROUND INTERIOR COLUMNS. NO EXPANSION JOINT MATERIAL SHALL BE USED.
- THE GENERAL CONTRACTOR SHALL INSTALL A 5" WIDE 11GA (1/8" THICK) STAINLESS STEEL THRESHOLD WITH COUNTERSUNK SCREWS AND SET IN A FULL BED OF SLOCCO TO THE FLOOR FOR DISMISSAL FLOOR FINISHES/RESINOUS FLOOR AND CONCRETE, VCT AND CONCRETE, RESINOUS FLOOR AND VCT, QUARRY TILE & VCT. GC SHALL INSTALL A BEVELED ADA COMPLIANT MARBLE THRESHOLD AT RESTROOM DOORS (4" WIDE x 5/8" HIGH).
- EXTERIOR SURECRETE APPLICATION SHALL BE SURECRETE DESIGN PRODUCTS "SURESPRAY PERBLE TEXTURE" COLOR "FLUOR". GC SHALL SEAL WITH SUREDECK SOLVENT-BASED OR SURESEAL WATER-BASED FLOWABLE SEALER.
- RESINOUS DECORATIVE FLOORING
RESINOUS FLOORING TO TAPER OFF FLUSH WITH CONCRETE BEHIND COOLER PANEL. DO NOT INSTALL A METAL TRANSITION STRIP.
- RESINOUS DECORATIVE FLOORING SHALL BE PURCHASED FROM DUR-A-FLEX INC. CONTACT KEVIN STEPHENS AT (919) 208-8662 OR FROM PROTECTIVE INDUSTRIAL POLYMERS, CONTACT STEVE MCCAMEY AT (804) 937-5000.
- COORDINATE RESINOUS FLOOR LAYOUT WITH CASE INSTALLER.
- QUARRY/CERAMIC/PORCELAIN TILE
THE GENERAL CONTRACTOR SHALL CLEAN ALL EXISTING TILE IN THE RESTROOMS, MEAT PREP, MEAT COOLER, MEAT STORAGE, DELI/BAKERY PREP, DELI/BAKERY COOLER AND DELI/BAKERY STORAGE. ANY REPAIR OR RENOVATIONS TO BE DONE WITH MATCHING MATERIALS. COORDINATE ALL WORK WITH THE PLUMBING SLAB AND DEMO PLANS ALONG WITH THE FOOD LION CONSTRUCTION MANAGER PRIOR TO COMMENCING WORK.
- INSTALL NEW QUARRY, CERAMIC OR PORCELAIN TILE AT A 90° ANGLE TO THE WALL, UNLESS OTHERWISE NOTED; LEVEL WITH FINISHED FLOOR. MATCH EXISTING.
- RESTROOMS, MEAT PREP, MEAT COOLER, MEAT STORAGE, DELI/BAKERY PREP, DELI/BAKERY COOLER AND DELI/BAKERY STORAGE SHALL HAVE EPOXY GROUT CONFORMING TO TSM 448H HT, ANSI A118.3; FOR ANY REPAIR/REMODEL WORK.
- FLOOR TILE MANUFACTURER SHALL PROVIDE A LETTER CERTIFYING ALL TILES ARE SLIP RESISTANT IN ACCORDANCE WITH CARB/ANSI 117.1-2009 SECTION 302.

FLOOR FINISH LEGEND:

- REFER TO SPECIFIC AREA NOTE FOR DETAILED FLOORING INFORMATION
- NEW PERIMETER/FULL VCT FLOORING
 - NEW CENTER STORE/FIXTURE & REPAIR VCT FLOORING
 - NEW RESINOUS DECORATIVE FLOORING
 - NEW SURECRETE CONCRETE SEALER
 - NEW CARPET TILES
 - NEW CONCRETE
 - 12" WIDE PAINTED RAT STRIPE

REVISIONS

NO	DATE	REMARKS

FOOD LION
2110 Executive Drive, Salisbury, NC 28147
Telephone: 704.633.8250
Food Lion is an AMOLD INC. COMPANY.

FOOD LION REMODEL STORE #2839
860 PARRIS ISLAND GTWY
BEAUFORT, SC 29906

PROJECT NO: 2021.1218
DATE: 7/5/22

13 OF 54
A1.05
FLOOR FINISH PLAN

CHECKED: DNC DRAWN: DNC/EC
DATE: 07/01/2022 5:23:51 PM

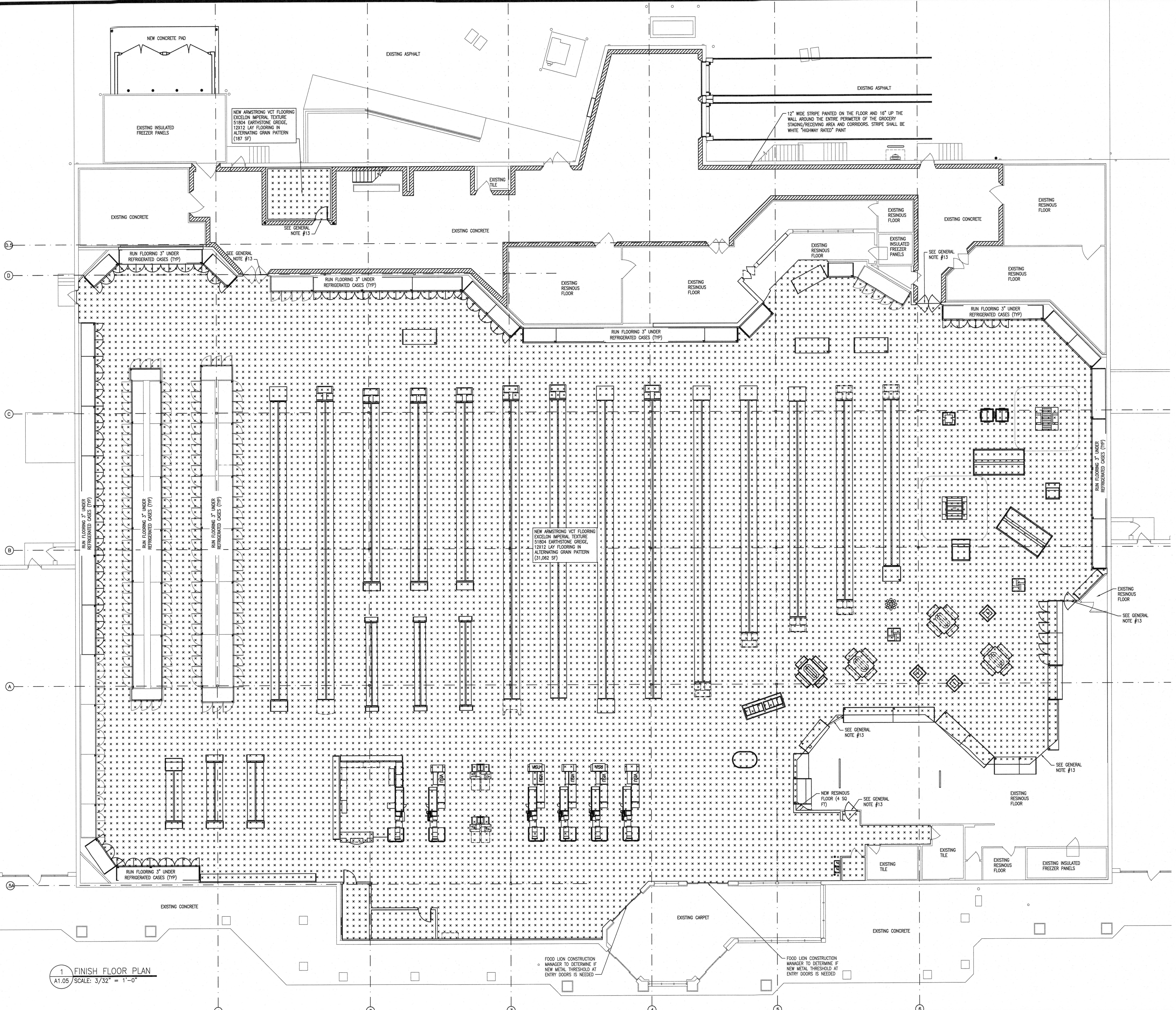

1 FINISH FLOOR PLAN
A1.05 SCALE: 3/32" = 1'-0"

2 CARPET TRANSITION DETAIL
A1.05 SCALE: NTS

FOOD LION CONSTRUCTION MANAGER TO DETERMINE IF NEW METAL THRESHOLD AT ENTRY DOORS IS NEEDED