

OCCUPANT TYPE	GROSS AREA	SF/PERSON	ALLOWABLE LOAD
PREP	3,553 SF	200	18 OCCUPANTS
STORAGE	6,900 SF	300	23 OCCUPANTS
SALES AREA	33,674 SF	60	561 OCCUPANTS
ACCESSORY (OFFICE USE)	388 SF	300	1 OCCUPANTS
TOTAL			603 OCCUPANTS

LEGEND

- PREP/STORAGE (AREA) (OCC. LOAD)
- ACCESSORY (CONFRANCE) (OCC. LOAD)
- ACCESSORY (AREA) (OCC. LOAD)
- SALES AREAS (AREA) (OCC. LOAD)
- EGRESS ROUTE
- MOST REMOTE POINT
- EXIT SIGN
- EMERGENCY LIGHTS
- EXIT
- DOOR CLEAR WIDTH
- DOOR ALLOWABLE OCCUPANT LOAD

EGRESS PER 2018 IBC

CLEAR WIDTH PROVIDED	REQUIRED	2' x OCCUPANT	603 OCCUPANTS
117"	2'	x	2
34"	2'	x	2
68"	2'	x	2
34"	2'	x	2
TOTAL	404'	120.6'	

EXITS PROVIDED	REQUIRED
6	3

TRAVEL DISTANCE MAX	REQUIRED	ACTUAL
250'	207'	207'

EXIT SEPARATION PROVIDED MIN	REQUIRED MIN
209'	304'/3" DIAGONAL
	101'-4"

- LIFE SAFETY GENERAL NOTES:**
- MERCANTILE ALTERATION DESIGNED UNDER 2018 IBC.
 - THIS BUILDING IS TYPE II-B CONSTRUCTION, MERCANTILE OCCUPANCY, SPRINKLERED.
 - MAXIMUM ALLOWABLE EXIT ACCESS DISTANCE = 250' (MERCANTILE)
 - MAXIMUM ALLOWABLE COMMON PATH OF TRAVEL DISTANCE = 75'
 - MAXIMUM ALLOWABLE DEAD END TRAVEL DISTANCE IN CORRIDORS = 50'
 - CLEAR OPENING WIDTH FOR A SINGLE 36" WIDE DOOR SHOULD BE CONSIDERED 34" TO COMPENSATE FOR STOP, DOOR THICKNESS AND HINGE THROW.
 - SEE SHEET A1.03 GENERAL NOTE #10 FOR FIRE EXTINGUISHER REQUIREMENTS.
 - FIRE EXTINGUISHER SIGNS FOR CURVED SURFACES (INCLUDING ROUND AND SQUARE COLUMNS) - PROVIDE 18"H X 4"W GLOW-IN-THE-DARK ADHESIVE SIGN EQUAL TO BRADY SV184G (GRANGER ITEM #32MD69).
 - FIRE EXTINGUISHER SIGNS FOR FLAT WALL SURFACES - PROVIDE 18"H X 4"W GLOW-IN-THE-DARK PLASTIC SIGN EQUAL TO ACCUFORM SIGNS MFK65516P (GRANGER ITEM #8FZW).
 - ALL EXITS ARE TO EXISTING TO REMAIN UNCHANGED UNLESS NOTED OTHERWISE.

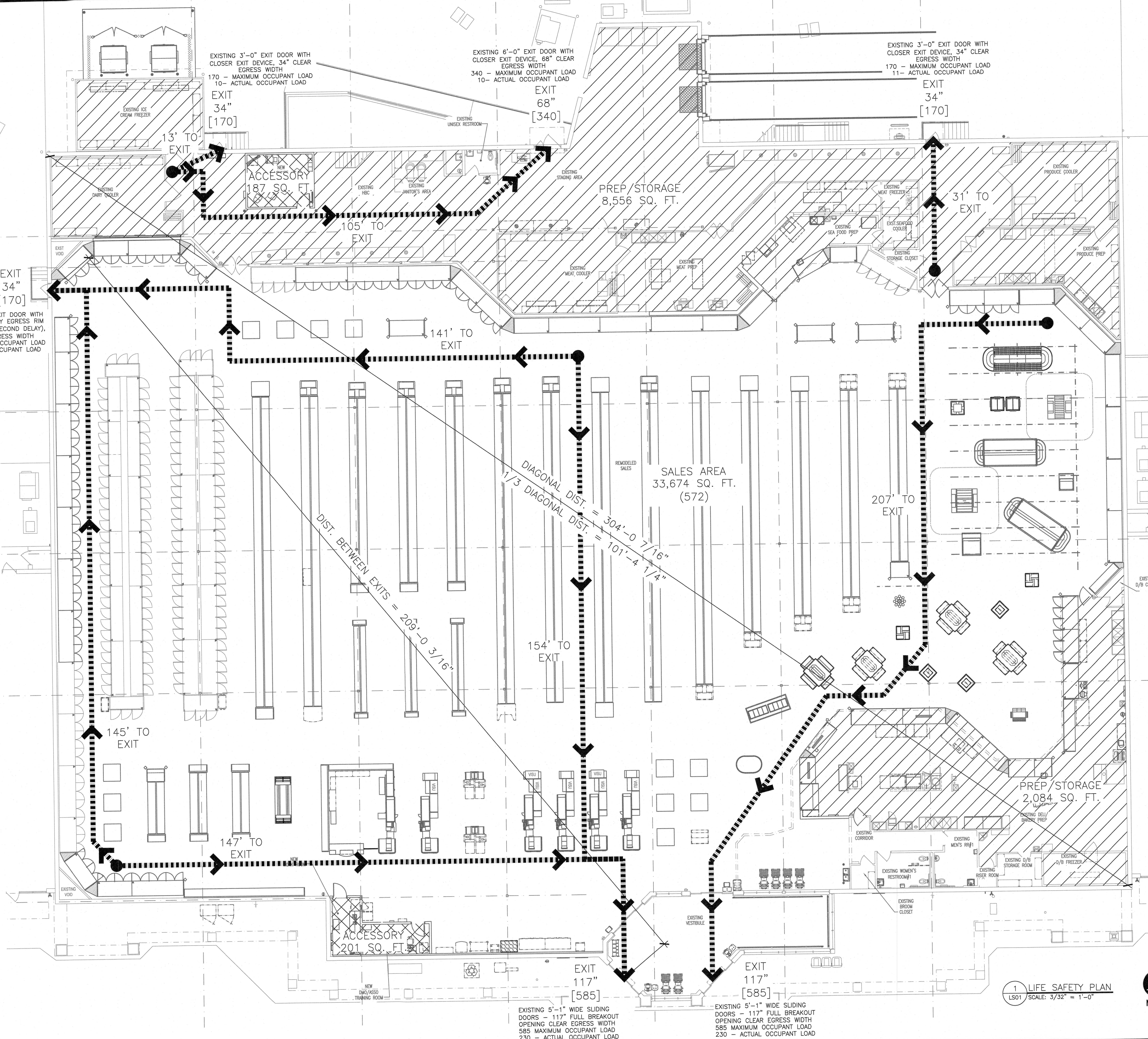

1 LIFE SAFETY PLAN
LS01 SCALE: 3/32" = 1'-0"



EXISTING 5'-1" WIDE SLIDING DOORS - 117" FULL BREAKOUT OPENING CLEAR EGRESS WIDTH 585 MAXIMUM OCCUPANT LOAD 230 - ACTUAL OCCUPANT LOAD

EXISTING 5'-1" WIDE SLIDING DOORS - 117" FULL BREAKOUT OPENING CLEAR EGRESS WIDTH 585 MAXIMUM OCCUPANT LOAD 230 - ACTUAL OCCUPANT LOAD

EXISTING 3'-0" EXIT DOOR WITH CLOSER AND DELAY EGRESS RIM EXIT DEVICE (15 SECOND DELAY), 34" CLEAR EGRESS WIDTH 170 - MAXIMUM OCCUPANT LOAD 112 - ACTUAL OCCUPANT LOAD

EXISTING 3'-0" EXIT DOOR WITH CLOSER EXIT DEVICE, 34" CLEAR EGRESS WIDTH 170 - MAXIMUM OCCUPANT LOAD 10 - ACTUAL OCCUPANT LOAD

EXISTING 6'-0" EXIT DOOR WITH CLOSER EXIT DEVICE, 68" CLEAR EGRESS WIDTH 340 - MAXIMUM OCCUPANT LOAD 10 - ACTUAL OCCUPANT LOAD

EXISTING 3'-0" EXIT DOOR WITH CLOSER EXIT DEVICE, 34" CLEAR EGRESS WIDTH 170 - MAXIMUM OCCUPANT LOAD 11 - ACTUAL OCCUPANT LOAD

EXIT 34" [170]

EXIT 68" [340]

EXIT 34" [170]

EXIT 34" [170]

13' TO EXIT

ACCESSORY 187 SQ. FT.

105' TO EXIT

PREP/STORAGE 8,556 SQ. FT.

31' TO EXIT

141' TO EXIT

SALES AREA 33,674 SQ. FT. (572)

207' TO EXIT

DIST. BETWEEN EXITS = 208'-0 3/16"

DIAGONAL DIST. = 304'-0 7/16"
1/3 DIAGONAL DIST. = 101'-4 1/4"

154' TO EXIT

145' TO EXIT

147' TO EXIT

ACCESSORY 201 SQ. FT.

EXIT 117" [585]

EXIT 117" [585]

PREP/STORAGE 2,084 SQ. FT.