



**REFLECTED CEILING LEGEND**

<b>LIGHTING: (SEE ELECTRICAL)</b>		<b>HVAC &amp; VENTILATION: (SEE MECHANICAL)</b>	
	NEW LIGHTS		EXISTING DIFFUSER
	RELOCATED LIGHTS		NEW RELOCATED DIFFUSER
	EXISTING LIGHTS		EXISTING RETURN
	EXISTING LIGHTS TO BE REMOVED		NEW RELOCATED RETURN
	NEW NIGHT LIGHTS		EXISTING EXHAUST FAN
	NEW LIGHTS WITH TUBE SHIELDS		NEW RELOCATED EXHAUST FAN OR TRANSFER FAN
	EXISTING COOLER/FREEZER LIGHTS. SEE ELECTRICAL DRAWINGS FOR REPLACEMENTS		EXISTING EVAPORATOR
	NEW RELOCATED COOLER/FREEZER LIGHTS		NEW RELOCATED EVAPORATOR
	EXISTING EXIT LIGHTS		EXISTING CEILING FANS
	NEW RELOCATED EXIT LIGHTS		
	EXISTING EMERGENCY LIGHTS		
	NEW EMERGENCY LIGHTS		
	EXISTING EMERGENCY EXIT LIGHT		

**REFER TO SHEET A6.01 FOR FINISH MATERIALS LEGEND**

**CEILING TYPES:**

	CEILING HEIGHT		GYPSUM BOARD OR DRYS. PAINTED		FIRE RETARDANT PLYWOOD OR PREFAB CEILING
	EXISTING SUSPENDED CEILING		EXPOSED STRUCTURE		EXTERIOR VINYL SOFFIT
	NEW SUSPENDED CEILING				

**GENERAL NOTES:**

1. CEILING HEIGHTS FOR ALL NEW CEILINGS SHALL BE AS NOTED IN ALL ROOMS.
2. CEILING GRID TO BE 2'-0"X4'-0" T-BARS LAID OUT FROM CENTER LINES IN BOTH DIRECTIONS. LAY OUT SO THAT NO TILE LESS THAN HALF SIZE WILL BE USED. EXCEPT AS NOTED, MAIN RUNNERS TO BE 4'-0" ON CENTER WITH MAIN RUNNERS AT ALL LIGHT FIXTURES.
3. GENERAL CONTRACTOR TO COORDINATE THE LOCATION OF SPRINKLER HEADS, LIGHT FIXTURES AND DIFFUSERS IN ALL AREAS WITH ASSOCIATIVE SUB-CONTRACTORS.
4. PREP AREA CEILING TILE TO BE A F.R.P. LINED, FOAM PANEL BY NUDD PRODUCTS INC. 2508 S. GRAND AVE. E. SPRINGFIELD, ILLINOIS 62707 PHONE: 1-800-826-4132 - SEE SPECIFICATIONS.
5. RELOCATE EXISTING LIGHT FIXTURES AS NOTED, UNLESS DAMAGED. COORDINATE WITH FOOD LION CONSTRUCTION MANAGER.
6. THE CONTRACTOR SHALL FURNISH TWO EXTRA BOXES OF CEILING TILE FOR EVERY NEW TYPE OF TILE USED IN THE STORE. TO BE LEFT AT THE STORE FOR FUTURE USE.
7. IF APPLICABLE, THE REMOVAL OF EXISTING CEILING TILE IS TO BE DONE BEFORE REMOVAL OF RACK/OVEN GR HOOD. NEW RACK/OVEN GR HOOD TO BE INSTALLED BEFORE NEW CEILING IS INSTALLED IN THIS AREA. COORDINATE WITH THE FOOD LION CONSTRUCTION MANAGER.
8. THE GENERAL CONTRACTOR SHALL VERIFY THE EXISTING LIGHTING LAYOUT. ANY DISCREPANCIES TO THE LAYOUT SHOWN SHALL BE IMMEDIATELY BROUGHT TO THE ATTENTION OF THE FOOD LION CONSTRUCTION MANAGER.
9. GENERAL CONTRACTOR SHALL REPAIR THE CEILING GRID & INSTALL NEW TILE WHERE LIGHT FIXTURES HAVE BEEN REMOVED. COORDINATE WITH FOOD LION CONSTRUCTION MANAGER.
10. ALL REPLACED CEILING GRID AND TILE SHALL MATCH EXISTING CEILING IN MATERIAL, COLOR, HEIGHT, AND LOCATION.
11. NEW CEILINGS IN SALES & SUPPORT AREAS TO BE 2x4 ARMSTRONG HUMAGUARD PLUS TILE IN PRELUDE XL GRID - SEE SPECIFICATIONS.
12. NEW CEILINGS IN PREP AREAS AND WET LOCATIONS TO BE 2x4 ARMSTRONG VINYL CLAD TILE IN PRELUDE XL GRID - SEE SPECIFICATIONS.
13. GENERAL CONTRACTOR TO PATCH/REPAIR EXISTING GWB CEILING AS NECESSARY WITH REMOVAL/INSTALLATION OF NEW LIGHTS AND EQUIPMENT.

**1 REFLECTED CEILING PLAN**  
SCALE: 3/32" = 1'-0"

**MECHANICAL MEZZANINE REFLECTED CEILING PLAN**  
SCALE: 3/32" = 1'-0"

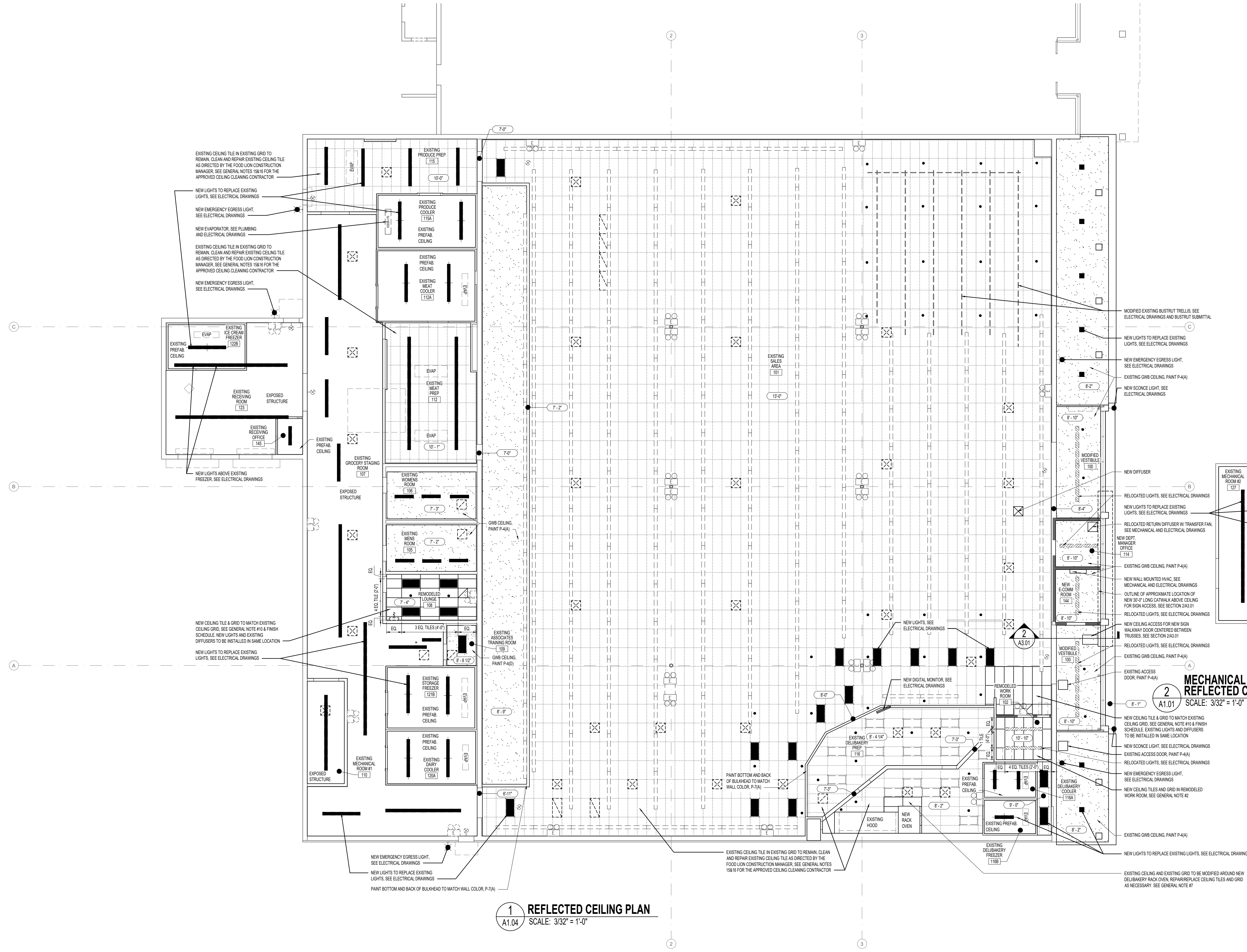

Plotfile: September 20, 2024 11:29:44 AM C:\2024\2654\00 (Food Lion) 2654 Flmhp\A1.04.dwg (User: William Hughes) Plotfile: 2024 09 20 11:29:44 AM C:\2024\2654\00 (Food Lion) 2654 Flmhp\A1.04.dwg