

OWNERSHIP OF INSTRUMENTS OF SERVICE:
All reports, specifications, plans, computer files, field data, and other documents and instruments of service shall remain the property of the Design Professional. The Design Professional shall retain the right to use the design and other reserved rights, including the copyright therein, in the making of the property of YCH Architects and not to be reproduced or copied in whole or any part. It is not to be used on any other project and is to be returned upon request. © Copyright 2024

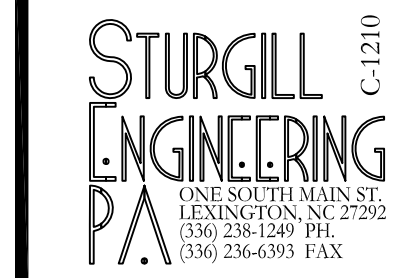

FOOD LION
STORE NO. 2654
INTERIOR ALTERATIONS
610 East King Street | Kings Mountain, NC 28086

ELECTRICAL DEMOLITION GENERAL NOTES

1. ALL ACCESSIBLE ITEMS OF ELECTRICAL EQUIPMENT CONDUITS, WIRING, LIGHTS, RECEPTACLES, ETC. AFFECTED BY THE RENOVATION WORK AND NOT REQUIRED IN THE COMPLETED WORK SHALL BE CAREFULLY REMOVED. DAMAGED WALLS, FLOORS, CEILINGS, ETC. SHALL BE PATCHED AND FINISHED TO MATCH THE EXISTING ADJACENT SURFACES. REMOVED ITEMS SHALL BE PROPERLY DISPOSED OF OFF SITE AND NOT RE-USED EXCEPT AS NOTED. TURN OVER ALL EXISTING EQUIPMENT DESIRED BY BUILDING OWNER. ITEMS TO BE RE-USED SHALL BE CAREFULLY REMOVED AND STORED IN A PROTECTED AREA.
2. REMOVE EXISTING CIRCUITS IN PANELS NOT REQUIRED FOR COMPLETED WORK. UTILIZE EXISTING BREAKERS FOR NEW WORK SHOWN. PROVIDE NEW BREAKERS AS REQUIRED TO SERVE NEW CIRCUITS. LABEL ALL BREAKERS. LABEL ALL BREAKERS NOT USED AS SPARE.
3. RECONNECT CIRCUITS AS REQUIRED TO MAINTAIN CONTINUITY TO EXISTING DEVICES AND EQUIPMENT NOTED TO REMAIN AS WELL AS ADJACENT AREAS WHICH ARE NOT IN CONTRACT.
4. REMOVE UNUSED CONDUIT AND WIRE BACK TO SOURCE.
5. ALL WIRING SHALL BE DONE IN STRICT ACCORDANCE WITH N.E.C. STANDARDS AND WITH FOOD LION STANDARDS. ALL WORK SHALL BE OF FIRST QUALITY. NO HAZARDOUS WORK WILL BE ACCEPTED. ELECTRICAL CONTRACTOR IS TO MAKE SURE THAT NO MC OR FLEX CABLES ARE USED UNLESS OTHERWISE NOTED. MC OR FLEX CABLES CAN ONLY BE USED IN SHORT RUNS FOR LIGHTING FEEDS. EMT MUST BE USED TO CONNECT PANEL TO JUNCTION BOX AND HAVE COMPRESSION TYPE FITTINGS. SEE SPECIFICATIONS FOR STANDARD PRACTICES.
6. DO NOT DISRUPT THE PULL STATIONS, SAFE, OR ANY COMPONENT OF THE FIRE OR SECURITY SYSTEM WITHOUT FIRST CONTACTING FOOD LION PHYSICAL SECURITY (AARON ASHLEY) AT (704) 633-8250 ext. 3128.
7. THE ELECTRICAL CONTRACTOR SHALL REVIEW THE HAZARDOUS MATERIAL REPORT, IF APPLICABLE, AND COORDINATE ALL HAZARDOUS MATERIAL REMOVAL WITH THE FOOD LION CONSTRUCTION SUPERVISOR.
8. THE ELECTRICAL CONTRACTOR SHALL PHOTOGRAPH OR VIDEOTAPE EXISTING CONDITIONS IN AND AROUND THE STORE PRIOR TO BEGINNING CONSTRUCTION. PARTICULAR ATTENTION SHOULD BE DIRECTED TO THE CEILING, ALL LIGHTING AND PANELS.
9. THE ELECTRICAL CONTRACTOR SHALL COORDINATE REMOVAL/RELOCATION OF LOTTERY EQUIPMENT WITH THE GENERAL CONTRACTOR AND THE FOOD LION CONSTRUCTION SUPERVISOR.
10. ANY WORK IN REST ROOMS TO BE SCHEDULED TO ALLOW FOR AT LEAST ONE TO REMAIN OPEN AT ALL TIMES. COORDINATE WITH FOOD LION CONSTRUCTION SUPERVISOR. PROPER SIGNAGE MUST BE INSTALLED WITH UNSEX RESTROOMS, USE SLIDE LOCK. PROVIDED BY FOOD LION.

ELECTRICAL DEMOLITION KEY NOTES

1. REFRIGERATED CASE TO BE REMOVED. COORDINATE REQUIREMENTS WITH THE REFRIGERATION CONTRACTOR.
2. EQUIPMENT TO BE REMOVED. ELECTRICAL CONTRACTOR SHALL DISCONNECT AS REQUIRED, REMOVE DEVICES, WIRE, CONDUITS, ETC. AND LABEL BREAKERS AS SPARE FOR NON-REUSED CIRCUITS.
3. REFRIGERATED CASE TO BE RELOCATED. ELECTRICAL CONTRACTOR SHALL DISCONNECT AS REQUIRED, REMOVE DEVICES, WIRE, CONDUITS, ETC. AND EXTEND CIRCUITRY AND RECONNECT AS REQUIRED TO NEW LOCATION.
4. EQUIPMENT TO BE RELOCATED. ELECTRICAL CONTRACTOR SHALL DISCONNECT AS REQUIRED, REMOVE DEVICES, WIRE, CONDUITS, ETC. AND EXTEND CIRCUITRY AND RECONNECT AS REQUIRED TO NEW LOCATION.
5. LIGHTING FIXTURE TO BE REMOVED / RELOCATED. SEE SHEET E1.01. ANY LIGHT FIXTURES TO BE REUSED ARE TO BE REMOVED AND STORED IN SUCH A MANNER THAT RENDERS THEM REUSABLE. GC SHALL STORE FIXTURES IN A SECURED TRAILER.
6. TRUSSIS AND ASSOCIATED TRACK LIGHTING TO BE REMOVED COMPLETE. REMOVE WIRE BACK TO SOURCE AND LABEL NON-REUSED BREAKERS AS "SPARE".
7. ELECTRICAL CONTRACTOR SHALL DISCONNECT CHECK STAND AND ASSOCIATED EQUIPMENT. ELECTRICAL CONTRACTOR SHALL PULL ALL POINT OF SALE EQUIPMENT, FOOD LION ELECTRICAL CONTRACTOR (MID-CAROLINA) SHALL RELOCATE AND/OR REMOVE AND DISPOSE OF CHECK STANDS. CIRCUITRY TO REMAIN FOR REUSE. COORDINATE WITH REVISED FIXTURE PLAN.
8. MILLWORK TO BE REMOVED. ELECTRICAL CONTRACTOR SHALL DISCONNECT AND REMOVE ANY EXISTING DEVICES, PCs, MONITORS, PRINTERS, ETC. AS REQUIRED. CIRCUITRY TO REMAIN FOR RECONNECTION. FIELD VERIFY EXISTING CONDITIONS AND EXTENT OF WORK. COORDINATE OVERNIGHT WORK WITH FOOD LION CONSTRUCTION SUPERVISOR 2 WEEKS PRIOR.
9. TRUSSIS AND ASSOCIATED TRACK LIGHTING TO BE RELOCATED. ELECTRICAL CONTRACTOR SHALL DISCONNECT AS REQUIRED, REMOVE DEVICES, WIRE, CONDUITS, ETC. AND EXTEND CIRCUITRY AND RECONNECT AS REQUIRED TO NEW LOCATION.
10. EVAP COIL TO BE REPLACED. DISCONNECT AS REQUIRED. CIRCUITS TO REMAIN FOR REUSE. COORDINATE WITH THE REFRIGERATION CONTRACTOR.
11. WALL SECTION TO BE DEMOLISHED. REMOVE ALL DEVICES, CONDUIT, WIRE, ETC. IN AFFECTED AREAS. CIRCUITS TO BE REROUTED TO NEW EQUIPMENT LOCATIONS. FIELD VERIFY EXTENT OF WORK.
12. ELECTRICAL CONTRACTOR TO COORDINATE WITH FOOD LION CONSTRUCTION SUPERVISOR AT TIME OF WALK THROUGH IF EXISTING SALES AREA FACING EMERGENCY AND EXIT SIGNS TO BE REPLACED WITH NEW WHITE FIXTURES.
13. EXISTING RECEPTION MECHANICAL EQUIPMENT TO BE REMOVED-DISCONNECT-AS REQUIRED-SEE SHEET E1.02-FOR CIRCUITRY TO REMAIN-FOR REUSE-REMOVE WIRE-BACK-TO-SOURCE-AND-LABEL-NON-REUSED-BREAKERS-AS-"SPARE". COORDINATE WITH THE MECHANICAL CONTRACTOR.
14. HAND DRYER TO BE REPLACED. EXTEND CIRCUITRY AS REQUIRED. COORDINATE REQUIREMENTS WITH THE NEW HAND DRYER.
15. PROPANE EXCHANGE LOCATION, ELECTRICAL CONTRACTOR SHALL FIELD VERIFY THAT ALL ELECTRICAL CONNECTIONS ARE CAPPED OFF WITHIN 5' OF THE FINAL LOCATION OF THE RELOCATED PROPANE EXCHANGES. ELECTRICAL CONTRACTOR SHALL REMOVE ALL WIRING AND CAP OFF CONDUITS.
16. CONDUITS ON THIS WALL TO BE RECESSED IN WALL OR REMOVED IF NOT USE.
17. REMOVE/RELOCATE EXISTING UPLIGHT LIGHTING FIXTURES. PROVIDE CIRCUITRY PROVISIONS NECESSARY TO MAINTAIN DOWNSTREAM LOADS.
18. RECEPTACLES, COMMUNICATIONS, DATA AND JUNCTION BOXES BELOW 48" AFF TO BE RELOCATED TO 48" AFF BEHIND NEW CABINET TO BE INSTALLED IN WORK ROOM.
19. REMOVE CEILING-MOUNTED RECEPTACLES U.O.N.
20. ELECTRICAL CONTRACTOR SHALL REMOVE UPS PANEL, UNUSED BYPASS SWITCH, AND ALL ASSOCIATED EQUIPMENT-ALL WALL OPENINGS CAUSED BY EQUIPMENT REMOVAL TO BE PROPERLY COVERED.
21. LIFE-MISER-PANEL-TO-BE-REMOVED-PANEL-1A-TO-BE-CONNECTED-DIRECTLY TO-MDP-2-(NO-HOT-WORK-ALLOWED)-COORDINATE-WITH-FOOD-LION-CONSTRUCTION-SUPERVISOR-EXACT-AMOUNT-OF-WORK-REQUIRED.
22. RELOCATE-LIGHT-SWITCH-IN-RESTROOM-TO-COORDINATE-WITH-DOOR-SWING-RELOCATION.
23. EXISTING PANEL TO BE REPLACED.
24. STORE-FRONT-SIGN-TO-BE-REPLACED-DISCONNECT-AS-REQUIRED-CIRCUITRY-TO-REMAIN-FOR-RECONNECTION-NEW-LED-SIGN-REQUIRES-ONE-JUNCTION-BOX-TERMINATE-THE-REST-FOR-FUTURE-USE.

ATM NOTE:
ELECTRICAL CONTRACTOR SHALL NOT UNPLUG ATM FOR ANY REASON. NO ONE IS ALLOWED TO USE THE ELECTRICAL OUTLET OR PHONE LINE JACK FOR ANY REASON. IT IS ILLEGAL TO ATTACH ANY DEVICE TO THE ATM LINE FOR ANY REASON. THE ONLY PEOPLE ALLOWED TO UNPLUG THE ATM ARE NATIONWIDE SERVICE AND THE COMPANY THAT REPLENISHES CASH IN THE ATM. COORDINATE ANY AND ALL WORK ASSOCIATED WITH THE ATM WITH FOOD LION CONSTRUCTION SUPERVISOR AND NATIONWIDE SERVICE AND/OR THE COMPANY THAT REPLENISHES CASH.

LEGEND

-----	ITEMS TO BE REMOVED AS NOTED ON PLAN
-----	ITEMS TO BE RELOCATED

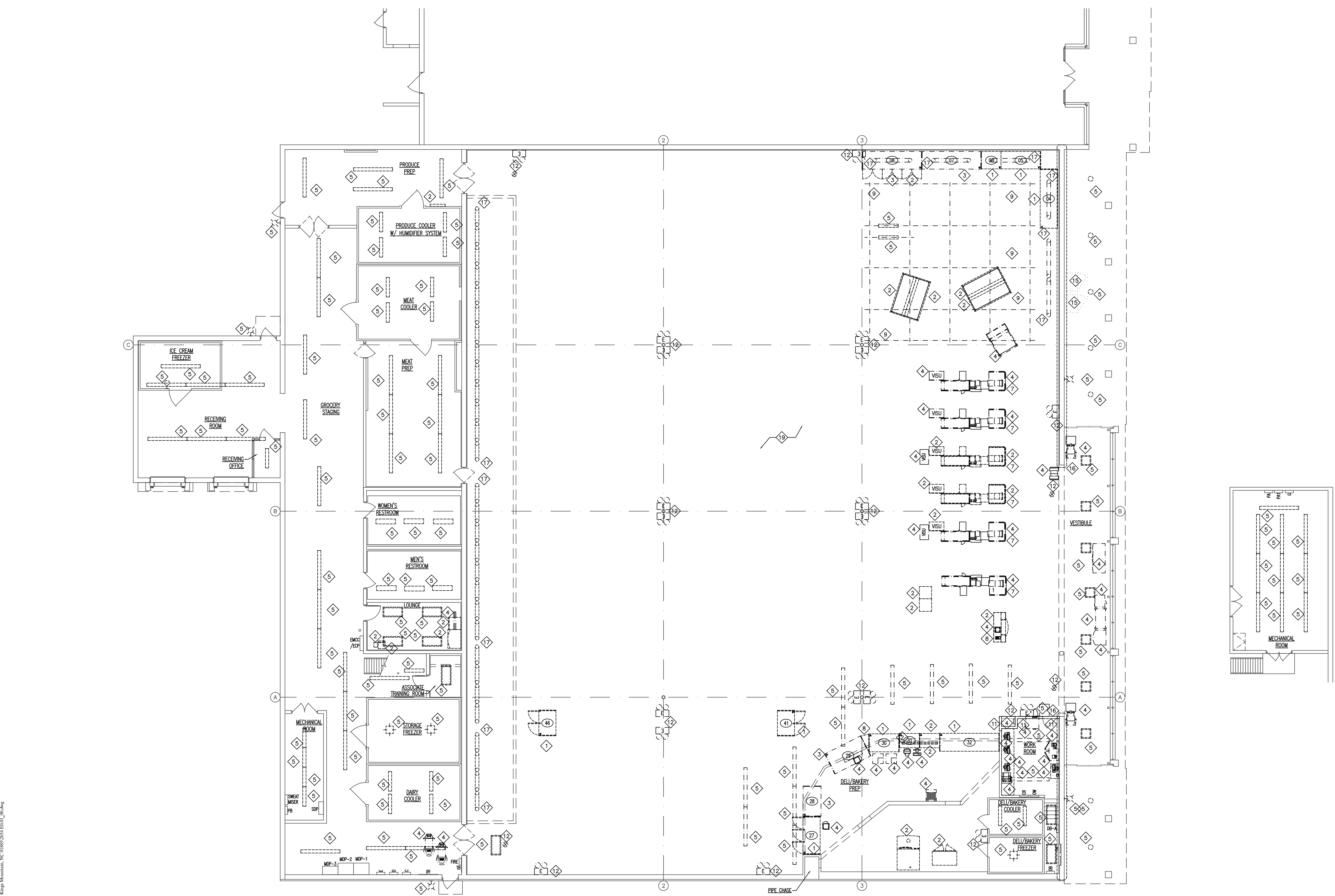

1 ELECTRICAL DEMO PLAN
E0.01 3/32" = 1'-0"