

OWNERSHIP OF INSTRUMENTS OF SERVICE:
All reports, specifications, plans, computer files, field data, drawings and other documents and instruments of service shall remain the property of the Design Professional. The Design Professional shall retain the right to use any and all information and other reserved rights, including the copyright therein, in the drawings in the project of YCH Architects and its use to be reproduced or copied in whole or any part. It is not to be used on any other project and is to be returned upon request. © Copyright 2024

CONSULTANT:
STURGILL ENGINEERING P.A.
1105 SOUTH MAIN STREET
LEWINGTON, NC 27202
(336) 238-1291 PHL
(336) 236-6993 FAX

CLIENT:
FOOD LION
2110 Executive Drive
Wm. H. Boyette Building
Wm. H. Boyette Building
Wm. H. Boyette Building

**FOOD LION
STORE NO. 2654
INTERIOR ALTERATIONS**
610 East King Street | Kings Mountain, NC 28086

FL PROJECT NO.: 2654FLMH2P4

FILE NAME: 2654 E1.02_00.dwg

YCHA COM. #: 22423.00

PHASE & DATE:
**Construction Documents
09-20-2024**

REVISIONS:

SHEET TITLE:
ELECTRICAL POWER PLAN

ARCHITECTURAL:
E1.02

LEGEND:

- ⊕ QUAD RECEPTACLE
- ⊕ JUNCTION BOX
- ⊕ WEATHER-RESISTANT DUPLEX RECEPTACLE
- ⊕ WEATHER-RESISTANT DUPLEX RECEPTACLE
- ⊕ GROUND FAULT INTERRUPTING RECEPTACLE
- ⊕ ISOLATED GROUND RECEPTACLE
- ⊕ SPECIAL USE RECEPTACLE, VOLTAGE, PHASE AND AMPERAGE BASED ON LOAD SERVED. COORDINATE NEMA CONFIGURATION WITH EQUIPMENT REQUIREMENTS.
- ⊕ FLOOR STUB UP
- ⊕ DISCONNECT SWITCH-TYPE AS NOTED
- ⊕ ELECTRICAL DROP FROM OVERHEAD
- ⊕ EXISTING ELECTRICAL STUB-UP
- ⊕ TELE-POWER POLE
- ⊕ ELECTRICAL CONNECTION UNDER CASE
- ⊕ MAGNETIC SWITCH (EXISTING)

TELEPOWER POLE INSTALLATION NOTES

- CONDUITS FROM "OT" & "OW" SHALL BE AS FOLLOWS:
(1) 2" CONDUITS FROM PANEL "OT" - TWO CHECKOUTS MAXIMUM PER CONDUIT. PROVIDE ADDITIONAL CONDUITS AS REQUIRED.
(2) 1" CONDUIT FROM PANEL "OW" DEDICATED TO DIRTY POWER FOR BELL MOTOR, SENSOR-WAIVE DEACTIVATION PANEL & GENERAL RECEPTACLES
- CASH REGISTER CIRCUITS SHALL BE PROVIDED WITH DEDICATED NEUTRAL AND GREEN DEDICATED CIRCUIT.
- EX CABLES SHALL BE INSTALLED WITH INSULATED THROATS AND APPROVED CONNECTORS.
- ELECTRICAL CONTRACTOR SHALL ENSURE THAT THE TELEPOLES ARE INSTALLED SECURE AND PLUMB; TOP CONNECTION OF TELEPOLE SHALL BE CONNECTED WITH A LEGRAND/WIREMOLD SLIDING SUPPORT, #E33204 (2-CHANNEL), THAT WILL ALLOW DEFLECTION OF THE BAR JOIST WITHOUT BOWING THE TELEPOLE.
- INSTALL ADAPTER TO REGISTER STAND TOP. A HOLE IS PROVIDED IN REGISTER STAND TOP (AND COUNTER TOP AT CUSTOMER SERVICE) AT THE DESIRED LOCATION. THE ADAPTER MUST BE INSTALLED SO THAT POLES GROMMET OPENING AND POWER CORD ARE FACING TOWARDS THE REAR OF THE STORE.
• TELEPOLES IN SALES AREA (PRODUCE, WINE, CENTER STORE, ETC.) - ELECTRICAL CONTRACTOR.
• TELEPOLES AFTER EQUIPMENT HAS BEEN SET. TELEPOLES SHALL BE PURCHASED THROUGH LOCAL LEGRAND/WIREMOLD DISTRIBUTOR. MODEL NUMBERS REFERENCED BELOW ARE FOOD LION SPECIFIC MODEL NUMBERS ASSIGNED BY LEGRAND/WIREMOLD. DISTRIBUTOR SHALL COORDINATE MODEL NUMBERS WITH LEGRAND/WIREMOLD. MODEL NUMBERS INCLUDE POLE ADAPTOR, TRIM PLATE, (2) TEE CLAMPS, 24"x24" CLEAR ANODIZED ALUMINUM POLES UNLESS NOTED OTHERWISE. MOUNT WITH LARGER DIMENSION OF THE TELEPOLE RUNNING BACK TO FRONT.
- COORDINATE EXACT TELEPOLE LOCATION WITH FOOD LION CONSTRUCTION MANAGER DURING TIME OF STORE SET.
• REAR SECTION OF TELEPOLE IS FOR POWER, FRONT SECTION IS FOR COMMUNICATIONS.

MODEL #'S BY ELECTRICAL CONTRACTOR (UNCL.)

A) FLAMP073
• SPL AMTP-415 15FT 2-CHANNEL POLE WITH (1) L5-20R, STANDARD GRAY BOOT
• 3x3 & 4x4 SLANT BINS

B1) FLAMP074
• SPL AMTP-415 15FT 2-CHANNEL POLE WITH (2) L6-20R (2 CIRCUITS), STANDARD GRAY BOOT
• 3x8 BIN, 3x8 BIN, 5x5 BERRY QUAD

B2) FLAMP074
• SPL AMTP-415 15FT 2-CHANNEL POLE WITH (2) L6-20R (2 CIRCUITS), (1) DUPLEX RECEPTACLE (1 CIRCUIT), STANDARD GRAY BOOT
• 3x8 BIN, 3x8 BIN, 5x5 BERRY QUAD

C) FLAMP079
• SPL AMTP-415 15FT 2-CHANNEL POLE WITH (2) L6-30R (2 CIRCUITS), STANDARD GRAY BOOT
• LARGE BERRY BIN

D) FLAMP077
• SPL AMTP-415 15FT 2-CHANNEL POLE NO RECEPTACLE REQUIRED, STANDARD GRAY BOOT
• WING BAR
• TUB CASES
• CUSTOMER SERVICE COUNTER
• SELF-CHECKOUTS
• FRUIT CASE ISLAND

E1) FLAMP074
• SPL AMTP-415 15FT 2-CHANNEL POLE WITH (1) L14-20R SIMPLEX, STANDARD GRAY BOOT
• SELF-CONTAINED (SHORT) WINE CASE (M-04-14-S)

E2) FLAMP074
• SPL AMTP-415 15FT 2-CHANNEL POLE WITH (1) L14-30R, STANDARD GRAY BOOT
• SELF-CONTAINED (TALL) WINE CASE (M-06-16-S)

F) FLAMP074
• SPL AMTP-415 15FT 2-CHANNEL POLE WITH (1) 5-20R SIMPLEX, STANDARD GRAY BOOT
• PET FRESH
• PET FRESH
• OLIVE BAR

S) E63302
• SPL AM CRV 15FT 1-CHANNEL SNAP-ON, NO RECEPTACLE REQUIRED.
• FOR USE WITH TYPE "D" FLAMP077 TO ADD CHANNEL WHEN NEEDED.
• SELF-CHECKOUT
• GRAB & GO

BY VENDOR

D1) FLAMP075 (LEFT HAND)
• SPL ALUMINUM 3-CHANNEL POLE WITH LANE LIGHT MOUNTING BRACKET #E6320 (2-1/4"x3-5/16")
• CHECKSTANDS, CUSTOMER SERVICE CHECKSTAND #1

DR) FLAMP076 (RIGHT HAND)
• SPL ALUMINUM 2-CHANNEL POLE WITH LANE LIGHT MOUNTING BRACKET #E6320 (2-1/4"x3-5/16")
• CHECKSTANDS

X) FLAMPX
• WHEN EXTENSION IS NEEDED, USE #AMP322 (2 CHANNEL) WITH SLIDING SUPPORT #E6320A.

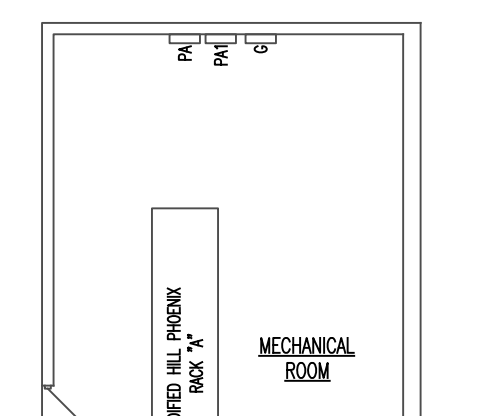

ELECTRICAL POWER PLAN (MEZZ)
E1.02 3/32" = 1'-0"

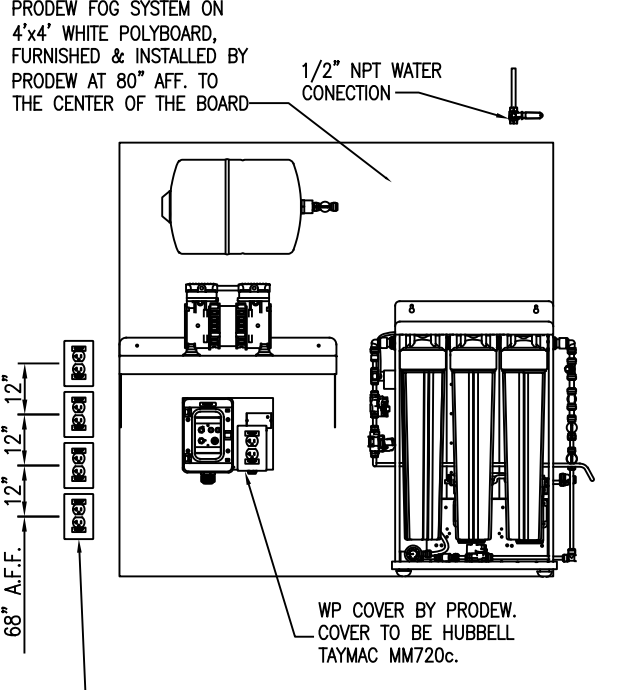

FOG SYSTEM DETAIL
E1.02 3/32" = 1'-0"

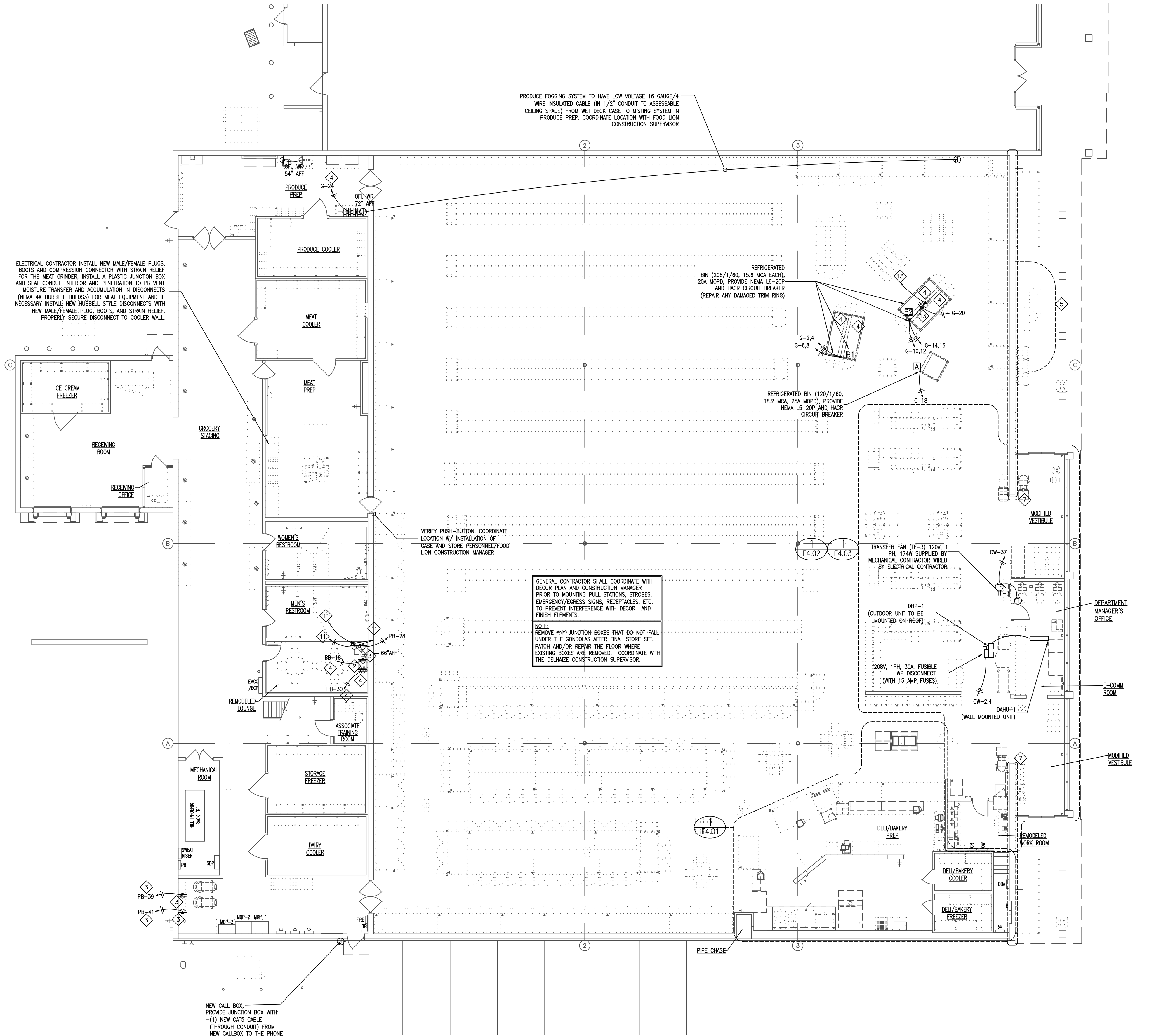

ELECTRICAL POWER PLAN
E1.02 3/32" = 1'-0"

Wednesday, September 18, 2024 4:16:52 PM 1/2024 - King Mountain, NC 10/18/2024 11:02 AM 0.00

ELECTRICAL CONTRACTOR INSTALL NEW MALE/FEMALE PLUGS, BOOTS AND COMPRESSION CONNECTOR WITH STRAIN RELIEF FOR THE MEAT COOLER. INSTALL A PLASTIC JUNCTION BOX AND SEAL CONDUIT INTERIOR AND PENETRATION TO PREVENT MOISTURE TRANSFER AND ACCUMULATION IN DISCONNECTS (NEMA 4X HUBBELL HELD) FOR MEAT EQUIPMENT AND IF NECESSARY INSTALL NEW HUBBELL STYLE DISCONNECTS WITH NEW MALE/FEMALE PLUG, BOOTS AND STRAIN RELIEF. PROPERLY SECURE DISCONNECT TO COOLER WALL.

GENERAL CONTRACTOR SHALL COORDINATE WITH DECOR PLAN AND CONSTRUCTION MANAGER PRIOR TO MOUNTING HALL STATIONS, STROBES, EMERGENCY/EGRESS SIGNS, RECEPTACLES, ETC. TO PREVENT INTERFERENCE WITH DECOR AND FINISH ELEMENTS.

NOTE: REMOVE ANY JUNCTION BOXES THAT DO NOT FALL UNDER THE CONDUIT AFTER FINAL STORE SET. PATCH AND/OR REPAIR THE FLOOR WHERE EXISTING BOXES ARE REMOVED. COORDINATE WITH THE DELHAIZE CONSTRUCTION SUPERVISOR.

TRANSFER FAN (1F-3) 120V, 1 PH, 174W SUPPLIED BY MECHANICAL CONTRACTOR WIRED BY ELECTRICAL CONTRACTOR

PRODUCE FOG SYSTEM ON 4"x4" WHITE POLYURETHANE, FURNISHED & INSTALLED BY PRODUCE AT 8'0" AFF TO THE CENTER OF THE BOARD

ELECTRICAL CONTRACTOR TO PROVIDE (4) GF/IMP DUPLEX RECEPTACLES (STAKED AT 12" O.C.) WITH EXTRA-LARGE IN-USE COVERS. COVERS TO BE HUBBELL TONING M4720C. RUN LOW VOLTAGE 16GA/4 WIRE INSULATED CABLE IN 1/2" CONDUIT ABOVE CEILING TO WET DECK CASE. ELECTRICAL AND PLUMBING TO BE COMPLETE PRIOR TO WET DECK CASE INSTALLATION.